

Grommet Bumpers



Applications: Sometimes called Button Bumpers or Push-in Bumpers, they come in two styles: round-headed or arrow-headed (pointed). Used extensively in automobiles, trucks, appliances and door frames, the ease of installation makes these very popular with metal fabricators in all industries. Also used to prevent metal-to-metal or surface-to-surface contact in door jambs, behind doors, between moving parts, and in applications where push-in parts work better than metal fasteners.

Materials: SBR, Nitrile, Neoprene, EPDM

Hardness: 30 to 80 Shore A Durometer

Colors: Black. Custom colors available. Please call for quotation.

Material Temperature Range: -60°F to +300°F, depending on material. See Material Performance Data for specific information.

Available in a variety of standard sizes. Custom sizes available, please call for quotation.

QCCP/N	Std P/N	A.Groove Width	B.Head Height	C.Bumper Height	D.Groove Dia.	E.Head Dia.	F.Bumper Dia.	Style
31150	0693	1/8	1/8	3/16	1/2	5/8	1	C
31500	0711	1/8	1/8	1/8	1/4	11/32	9/16	B
31920	1561	1/16	1/8	5/32	1/4	5/16	1/2	C
31980		3/16	1/8	3/16	11/32	1/2	3/4	C
32000		1/8	3/16	5/32	7/32	9/32	7/16	
32230	2250	3/16	3/16	5/16	1/2	11/16	1	B
32320	0963	0.065	3/32	3/16	1-9/32	1-5/8	2	C
32450	1178-2	1/16	3/16	5/32	3/16	1/4	1/2	A
32970	0734	1/16	1/8	1/4	1/16	5/16	1/2	B
33380	1138	5/64	5/32	1/8	9/32	3/8	9/16	B
33390	0986	1/16	1/16	1/8	1/4	5/16	3/8	B
33620	1257	1/32	7/64	3/32	5/32	7/32	3/8	B
34980	2376	1/2	11/64	3/32	1-1/32	1-1/2	1-5/16	B
61040	1178-1	1/16	3/16	3/32	3/16	1/4	1/2	A
61140	1422	1/8	11/64	11/32	9/32	7/16	5/8	C
61260	0520	1/8	1/16	1/16		5/16	3/8	B
61870	0740	1/16	3/32	5/32	11/32	13/32	9/16	B

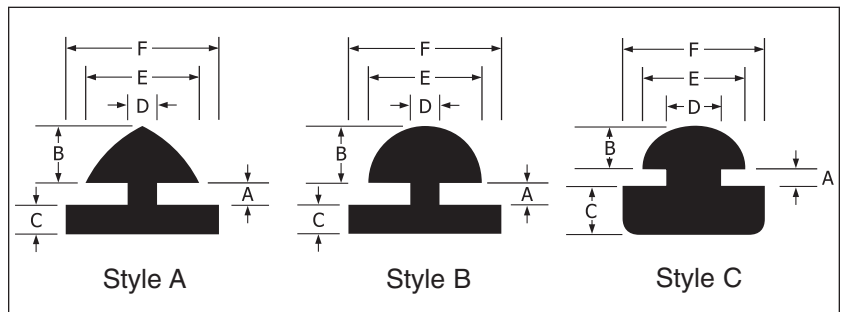

- A: Groove Width
- B: Head Height
- C: Bumper Height
- D: Groove Diameter
- E: Head Diameter
- F: Bumper Diameter

Visit us online at www.qccrubber.com to see our other fine products: Grommets, Stem Bumpers, Dock Bumpers, Recessed Bumpers, Vibra-Mounts and Snap Rings and more!

